

## WT100

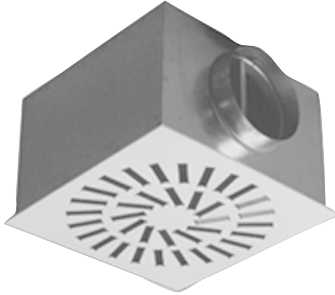

WT 100 swirl diffusers have adjustable baffles radially disposed, producing two different air throws: an internal or external vortex, or a vertical throw. The intense vortex allows a high induction with reduced throws, offering a low temperature gradient in the occupied zone.

**MATERIAL AND FINISH**

- Plate in painted steel, white RAL 9010
- The adjustable baffles are in black nylon
- Baffles in white (UPON REQUEST)
- Plenum in steel sheet
- ISOBOX-R series pyramid plenum in polystyrene foam
- Insulation, when required, is in polyethylene with th. 6 mm, **certified according to Euroclass B-s2-d0**.

**APPLICATION**

- Suitable for systems: VAV and CAV.
- Suitable for installation height between 2.7 and 4 m
- summer  $\Delta T$  up to -10 K and winter up to +15 K.

**FASTENING**

Diffuser connected to the plenum by central screw.

Plenum fastened to the ceiling by hanging.

**ACCESSORIES**

- BOX-WT101S plenum with side collar without insulation, with regulating damper and equalizer
- BOX-WT101T plenum with rear collar without insulation, with regulating damper and equalizer
- BOX-WT101SI insulated plenum with side collar, with regulating damper and equalizer
- BOX-WT101TI insulated plenum with rear collar, with regulating damper and equalizer.
- External insulation (UPON REQUEST)
- ISOBOX-R polystyrene distribution plenum with side collar in polypropylene, with regulating damper and complete with brackets for ceiling assembly. (See page 90)

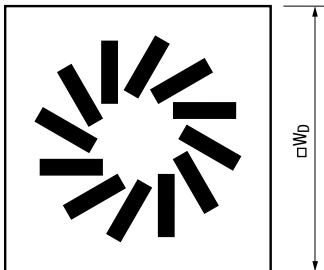

WT type 300 / 3 - 300 / 6  
400 / 4 - 400 / 6  
500 / 6

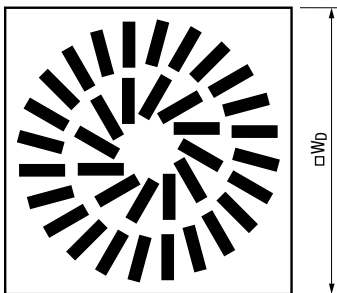

WT type 600 / 6

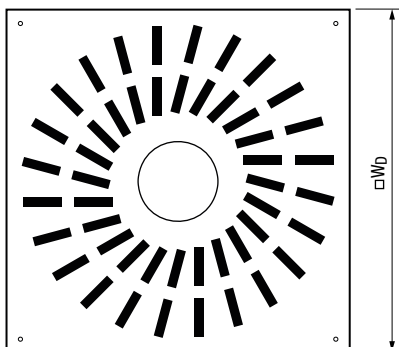

WT type 800 / 8

**PRICES**

| Model   | WT100 | Accessories |             |            |             |          |
|---------|-------|-------------|-------------|------------|-------------|----------|
|         |       | BOX-WT101T  | BOX-WT101TI | BOX-WT101S | BOX-WT101SI | ISOBOX-R |
| 300 / 3 | •     |             |             | •          | •           | ---      |
| 300 / 6 | •     |             |             | •          | •           | ---      |
| 400 / 4 | •     |             |             | •          | •           | ---      |
| 400 / 6 | •     |             |             | •          | •           | •        |
| 500 / 6 | •     |             |             | •          | •           | •        |
| 600 / 6 | •     |             |             | •          | •           | •        |
| 800 / 8 |       |             |             |            |             | ---      |

- Products in stock

**DIMENSIONS**

| Model   | Dimensions [mm] |             |
|---------|-----------------|-------------|
|         | □W <sub>D</sub> | Plenum size |
| 300 / 3 | 294             | 300         |
| 400 / 4 | 394             | 400         |
| 300 / 6 | 594             | 300         |
| 400 / 6 | 594             | 400         |
| 500 / 6 | 594             | 600         |
| 600 / 6 | 594             | 600         |
| 800 / 8 | 819             | 800         |

# WT100

## QUICK SELECTION

|                                     | Q <sub>min</sub> | Q <sub>max</sub> |
|-------------------------------------|------------------|------------------|
| Pressure drop [Pa]                  | 10               | < 30             |
| Noise level L <sub>WA</sub> [dB(A)] | < 30             | < 40             |

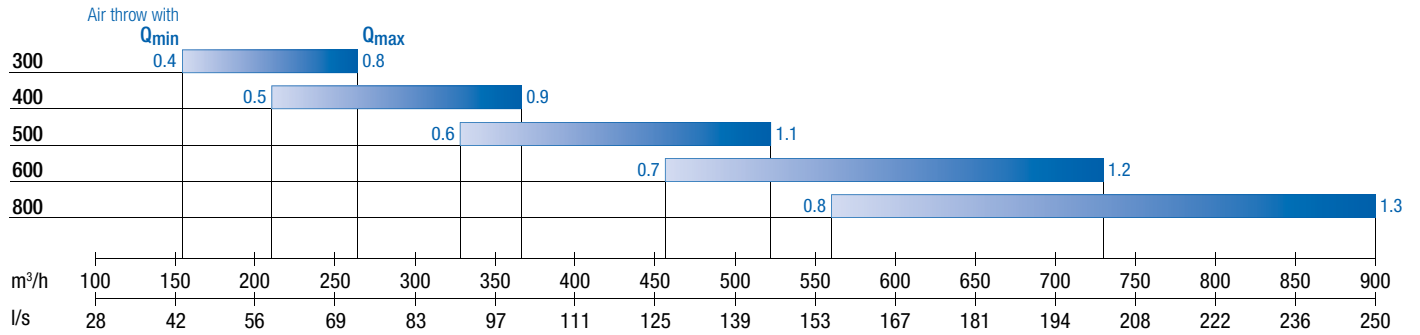

## ADJUSTMENT POSSIBILITIES

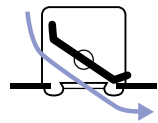

Outward flow

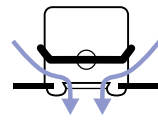

Vertical flow

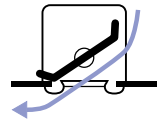

Inward flow

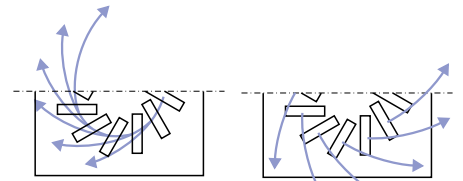
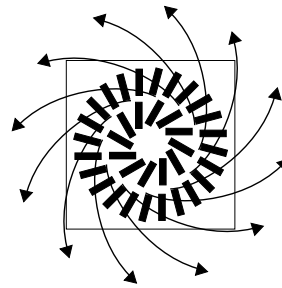

Example of baffle layout for outward swirl flow

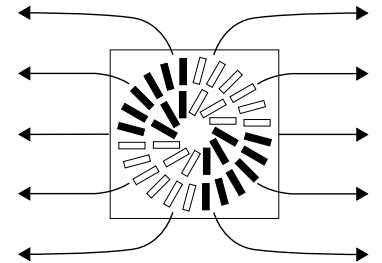
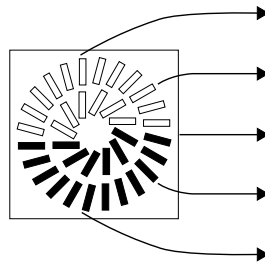

Example of baffle layout for one or two way flow

# WT100

## ACCESSORIES

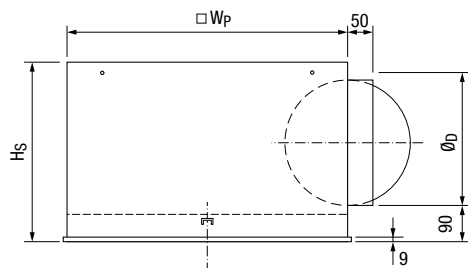

**BOX-WT101S plenum**  
Plenum side collar

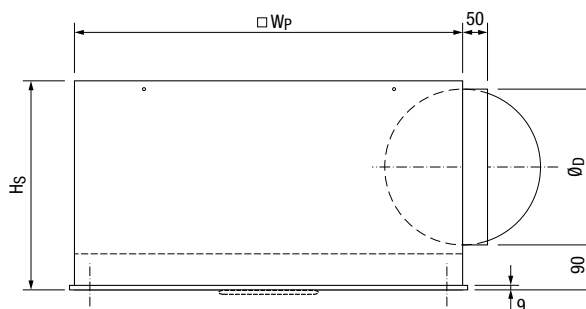

**BOX-WT101S 800/8 plenum**  
Plenum side collar

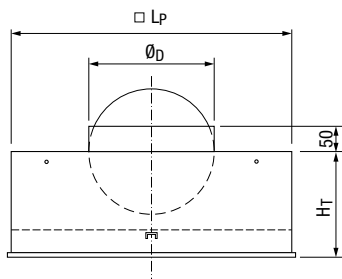

**BOX-WT101T plenum**  
Plenum top collar

| Model | Dimensions [mm] |       |       |                 |
|-------|-----------------|-------|-------|-----------------|
|       | $\square W_p$   | $H_T$ | $H_s$ | $\varnothing_D$ |
| 300   | 265             | 150   | 230   | 123             |
| 400   | 355             | 200   | 305   | 198             |
| 500   | 555             | 200   | 355   | 248             |
| 600   | 555             | 200   | 355   | 248             |
| 800   | 790             | ---   | 420   | 313             |

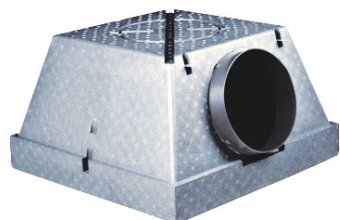

**ISOBOX-R plenums**  
Distribution plenum

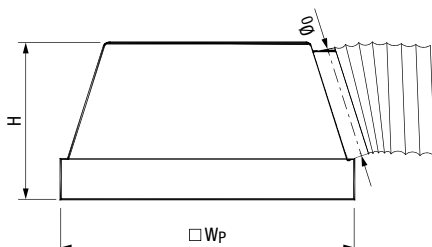

| Model                   | Dimensions [mm] |     |                 |
|-------------------------|-----------------|-----|-----------------|
|                         | $\square W_p$   | H   | $\varnothing_D$ |
| 600 - $\varnothing 200$ | 590             | 300 | 198             |
| 600 - $\varnothing 250$ | 590             | 350 | 248             |