

MPS



MPS adjustable multiple jet diffusers are used to distribute external air in large environments.

MATERIAL AND FINISH

- Plate in painted steel, white RAL9010
- Nozzles in aluminum, white RAL9010
- Plenum in galvanized sheet
- When required, insulation in chemically reticulate closed cell polyethylene foam with th. 6 mm. **Fire reaction B-s1-d0 according to EN13501-1.**

APPLICATION

- Suitable for large environments, such as shopping centers, stores, indoor sports facilities, cinemas and airports
- Wall mounting or on circular ducts using the element BR-MPS.

FASTENING

On the wall with clips using the counter-frame GR005-MPS.

With BPS-MPS and BPT-MPS plenums.

Fastening with visible screws when mounted on element for assembly on circular ducts.

ACCESSORIES

BPS-MPS	plenum with top circular collar.
BPSI-MPS	insulated plenum with top circular collar.
BPT-MPS	plenum with rear circular collar.
BPTI-MPS	insulated plenum with rear circular collar.
BR-MPS	assembly element for circular ducts.
GR005-MPS	counter-frame for wall-mounting.

PRICES

Model	MPS €	Accessories					
		GR005-MPS €	BR-MPS €	BPT-MPS €	BPTI-MPS €	BPS-MPS €	BPSI-MPS €
200 x 100							
300 x 100							
400 x 100							
500 x 100							
600 x 100							
700 x 100							
800 x 100							
900 x 100							
1000 x 100							
300 x 150							
450 x 150							
600 x 150							
750 x 150							
900 x 150							
1050 x 150							
1200 x 150							
200 x 200							
300 x 200							
400 x 200							
500 x 200							
600 x 200							
700 x 200							
800 x 200							
900 x 200							
1000 x 200							
300 x 300							
450 x 300							
600 x 300							
750 x 300							
900 x 300							
1050 x 300							
1200 x 300							

MPS

DIMENSIONS

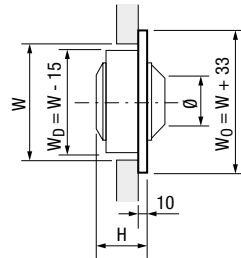
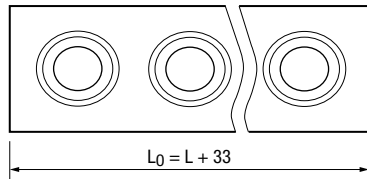

Ø = 44 mm	
L x W	Nr nozzles
200 x 100	2
300 x 100	3
400 x 100	4
500 x 100	5
600 x 100	6
700 x 100	7
800 x 100	8
900 x 100	9
1000 x 100	10

Ø = 61 mm	
L x W	Nr nozzles
300 x 150	2
450 x 150	3
600 x 150	4
750 x 150	5
900 x 150	6
1050 x 150	7
1200 x 150	8

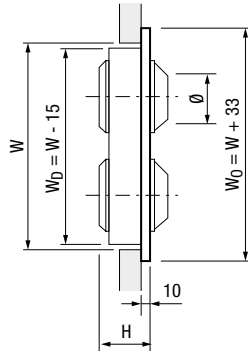
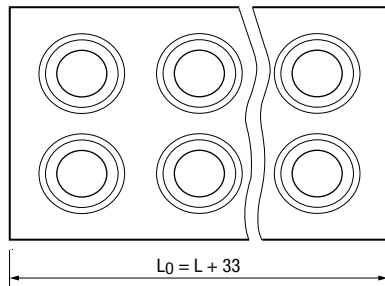

Ø = 44 mm	
L x W	Nr nozzles
200 x 200	4
300 x 200	6
400 x 200	8
500 x 200	10
600 x 200	12
700 x 200	14
800 x 200	16
900 x 200	18
1000 x 200	20

Ø = 61 mm	
L x W	Nr nozzles
300 x 300	4
450 x 300	6
600 x 300	8
750 x 300	10
900 x 300	12
1050 x 300	14
1200 x 300	16

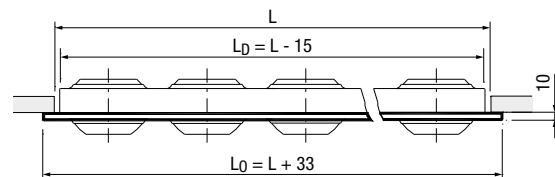

Dimensions [mm]				
L x W	Ø	Rows	H	W0
L x 100	44	1	46	133
L x 200	44	2	46	233
L x 150	61	1	63	183
L x 300	61	2	63	333

ELEMENT FOR CONNECTION TO CIRCULAR DUCT

BR-MPS

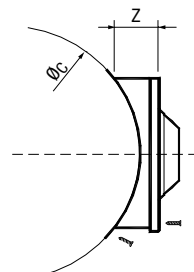

BR-MPS	Dimensions [mm]	
	Ø _C	Z
BR-MPS - Ø _C - L x 100	200 ÷ 1600	48
BR-MPS - Ø _C - L x 150	250 ÷ 1600	48
BR-MPS - Ø _C - L x 200	315 ÷ 1600	65
BR-MPS - Ø _C - L x 300	400 ÷ 1600	95

Ø_C = Duct diameter

MPS

QUICK SELECTION

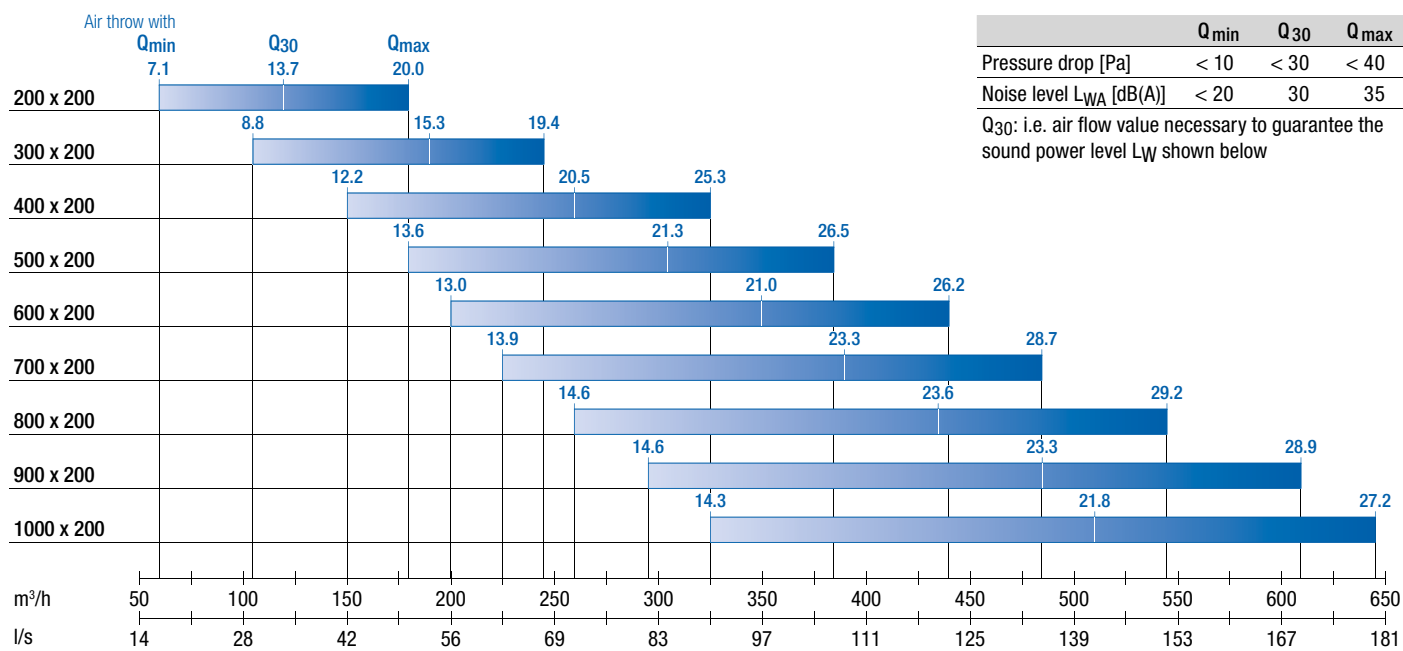
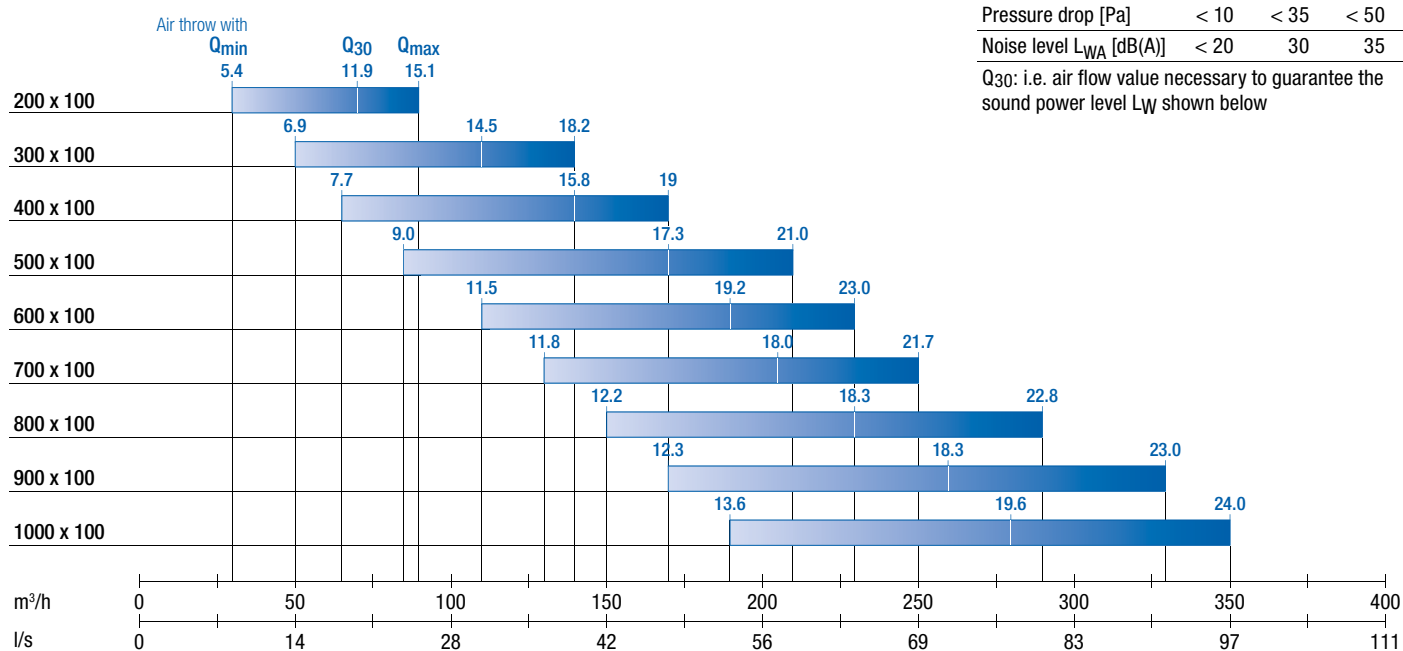

MPS

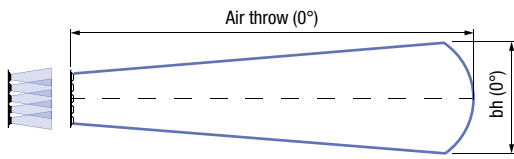

POSITION 1 (0°)

Air throw (0°) = Air throw
bh(0°) = 0.28 x Air throw

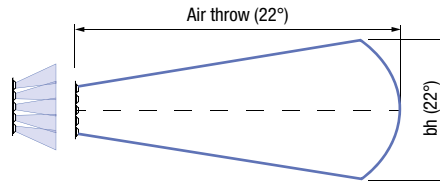

POSITION 2 (22°)

Air throw (22°) = 0.7 x Air throw
bh(22°) = 0.68 x Air throw

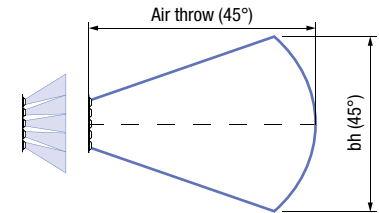

POSITION 3 (45°)

Air throw (45°) = 0.5 x Air throw
bh(45°) = 1.15 x Air throw

QUICK SELECTION

	Q _{min}	Q ₃₀	Q _{max}
Pressure drop [Pa]	< 10	< 20	< 35
Noise level L _{WA} [dB(A)]	< 20	30	35

Q₃₀: i.e. air flow value necessary to guarantee the sound power level L_W shown below

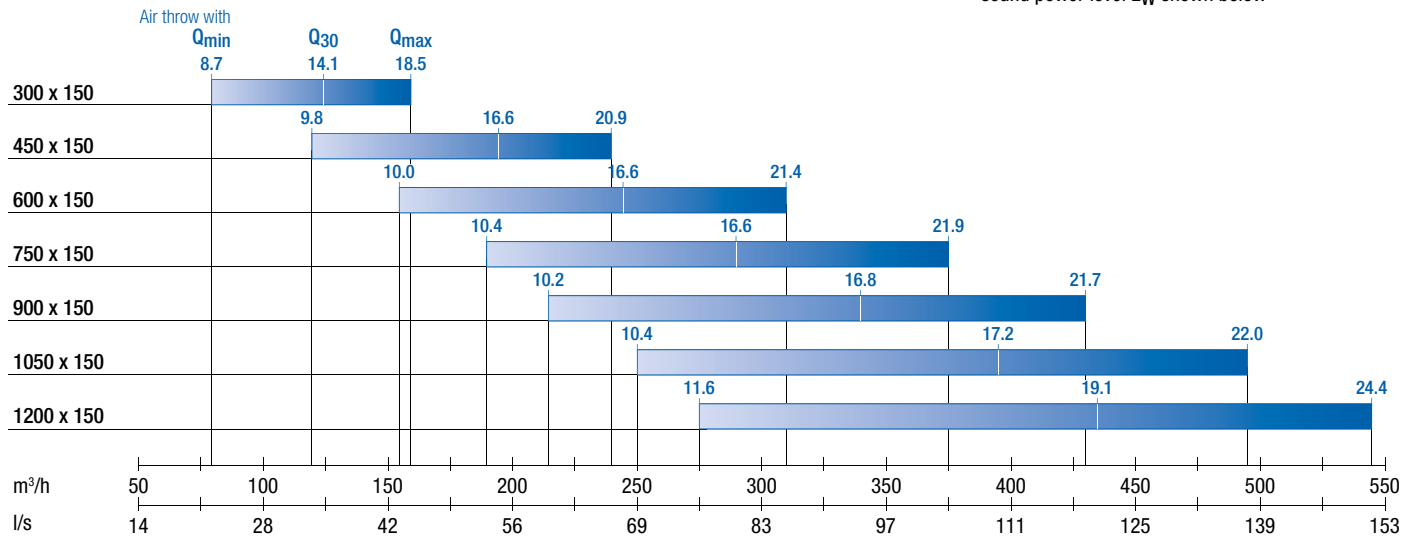

	Q _{min}	Q ₃₀	Q _{max}
Pressure drop [Pa]	< 10	< 25	< 40
Noise level L _{WA} [dB(A)]	< 20	30	35

Q₃₀: i.e. air flow value necessary to guarantee the sound power level L_W shown below

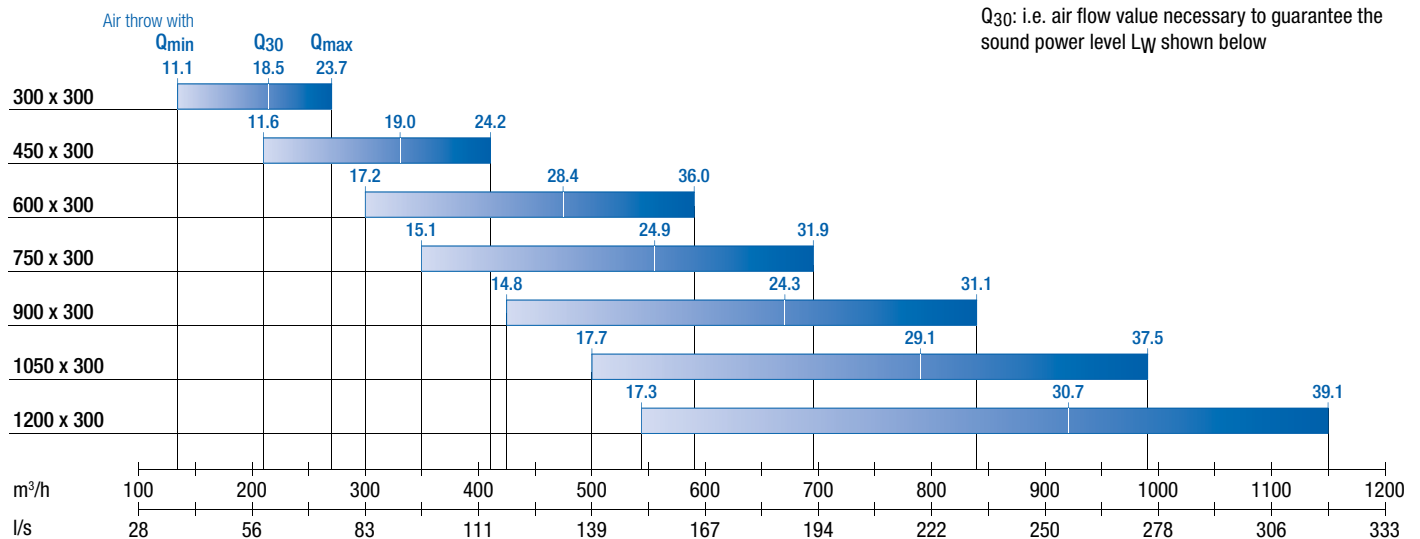

MPS

ACCESSORIES

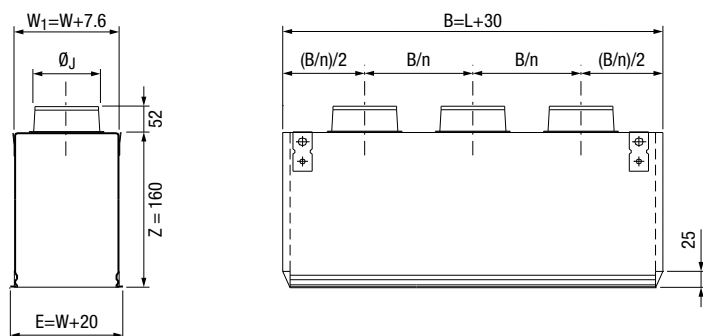

BPT-MPS

Plenum with rear circular collar

[mm] W	100	200
L	Nr connections / Ø _J	
200	1/100	1/200
300	1/100	1/200
400	1/100	1/200
500	1/100	1/200
600	2/100	1/200
700	2/100	1/200
800	2/100	1/200
900	2/100	2/200
1000	2/100	2/200

[mm] W	150	300
L	Nr connections / Ø _J	
300	1/125	1/250
450	1/125	1/250
600	2/125	1/250
750	2/125	1/250
900	2/125	1/250
1050	2/125	2/250
1200	3/125	2/250

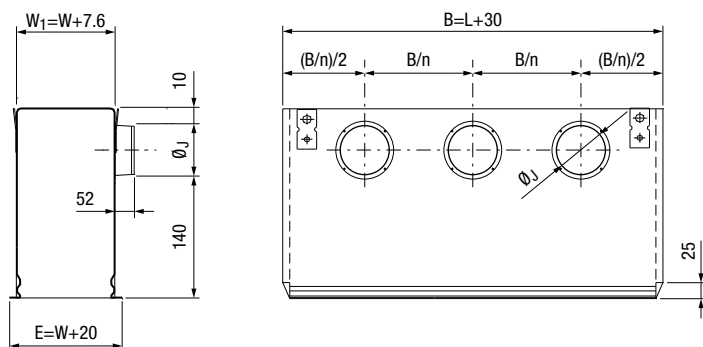

[mm] W	100	200
L	Nr connections / Ø _J	
200	1/125	1/200
300	1/160	1/200
400	1/160	1/250
500	1/200	1/250
600	1/200	1/250
700	2/200	2/200
800	2/200	2/200
900	2/200	2/250
1000	2/200	2/250

[mm] W	150	300
L	Nr connections / Ø _J	
300	1/200	1/250
450	1/200	1/315
600	2/200	1/315
750	2/200	2/250
900	2/200	2/315
1050	2/315	2/250
1200	3/200	3/315

BPS-MPS

Plenum with side circular collar