

RSVC-K / MA



The circular CAV regulator keeps the set air flow value constant with a 5% tolerance, regardless of the pressure and air flow variation, without the help of external energy. The regulator is not supplied pre-calibrated. The air flow can be set at the desired value using the external knob. Product suitable for civil applications.

MATERIAL AND FINISH

- Frame in galvanized steel in class C EN1751 with rubber gasket for air tightness.
- Blade in galvanized steel

VERSIONS

- RSVC-K / MA base
- RSVC-K / MA I1 thermal-acoustic insulation

DIMENSIONS AND PRICES

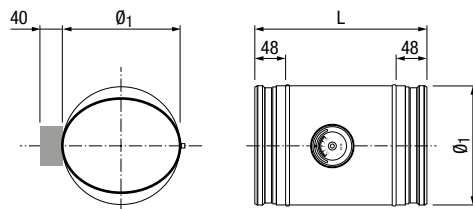

RSVC-K / MA

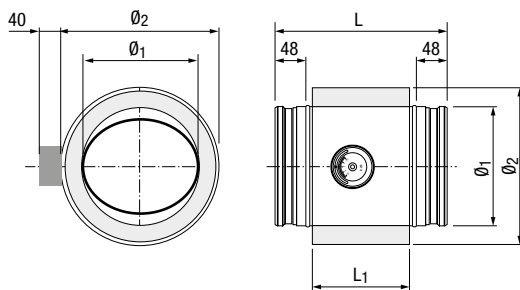

RSVC-K / MA I1

\varnothing_n	Dimensions [mm]				RSVC-K / MA	RSVC-K / MA I1	Air flow rate Q [m ³ /h]		Minimum differential pressure [Pa]*	
	\varnothing_1	\varnothing_2	L	L ₁	€	€	Q _{min}	Q _{max}	at Q _{min}	at Q _{max}
80	78	-	225	-	-	-	60	150	50	115
100	98	178	270	157			100	250	50	110
125	123	203	270	157	•		100	350	50	80
160	158	238	295	182	•		180	600	50	100
200	198	278	295	182	•		250	900	50	125
250	248	328	335	222	•		450	1200	50	135
315	313	393	340	227	•		700	2100	50	220
355	353	433	380	267			900	2600	50	220
400	398	478	420	307			1000	3400	50	220

* Maximum 1000 Pa

• Products in stock

Air flow rate regulation device

