

## RM.C / RMP



	RM.C	RMP
Class ISO 16890 Coarse	60%	40%
Class EN 779:2012	G4	G3
Medium	FS190 Synthetic fibre	FV50 Glass fibre
Support core	Cardboard	Metal
Protection discs	NO	Yes

Spares for automatic roll filters according to technical specifications

### ADVANTAGES

- Original products.
- Easy to replace.

### MATERIAL AND FINISH

- Steel or cardboard support core.
- Two different types of filtering media may be supplied:

- FS190: made up of self-extinguishing synthetic fibres arranged with increasing density.
- FV50: made up of long synthetic fibres bonded with thermoplastic resins, arranged with increasing density.

### VERSIONS

- MAT-ROLL RMCV
  - Glass fibre filter medium.
- MAT-ROLL RMPS
  - Synthetic fibre filter medium.

### DIMENSIONS

Code	Dimensions [mm]	RM.C
	L	€
RM.C 2	530	•
RM.C 3	830	•
RM.C 4	1130	•
RM.C 5	1430	•
RM.C 6	1730	•
RM.C 7	2030	•

- Products in stock

Code	Dimensions [mm]	RMP
	L	€
RMP 2	530	•
RMP 3	830	•
RMP 4	1130	•
RMP 5	1430	•
RMP 6	1730	•
RMP 7	2030	•

#### MAT-ROLL RM.C

Spare part in synthetic fibre for Roll-Filter C

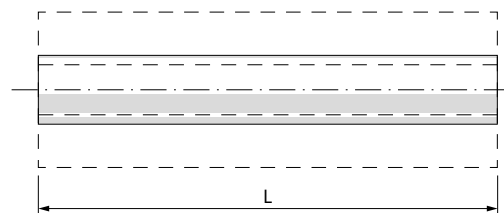

#### MAT-ROLL RMP

Spare part for other types of roll filters with metal core and glass fibre filter medium

